



#MAGGIE GOES TO...



We are here on the Maggie site in Shariya town in Kurdistan Region of Iraq.

watch movie: <https://vimeo.com/344874378>

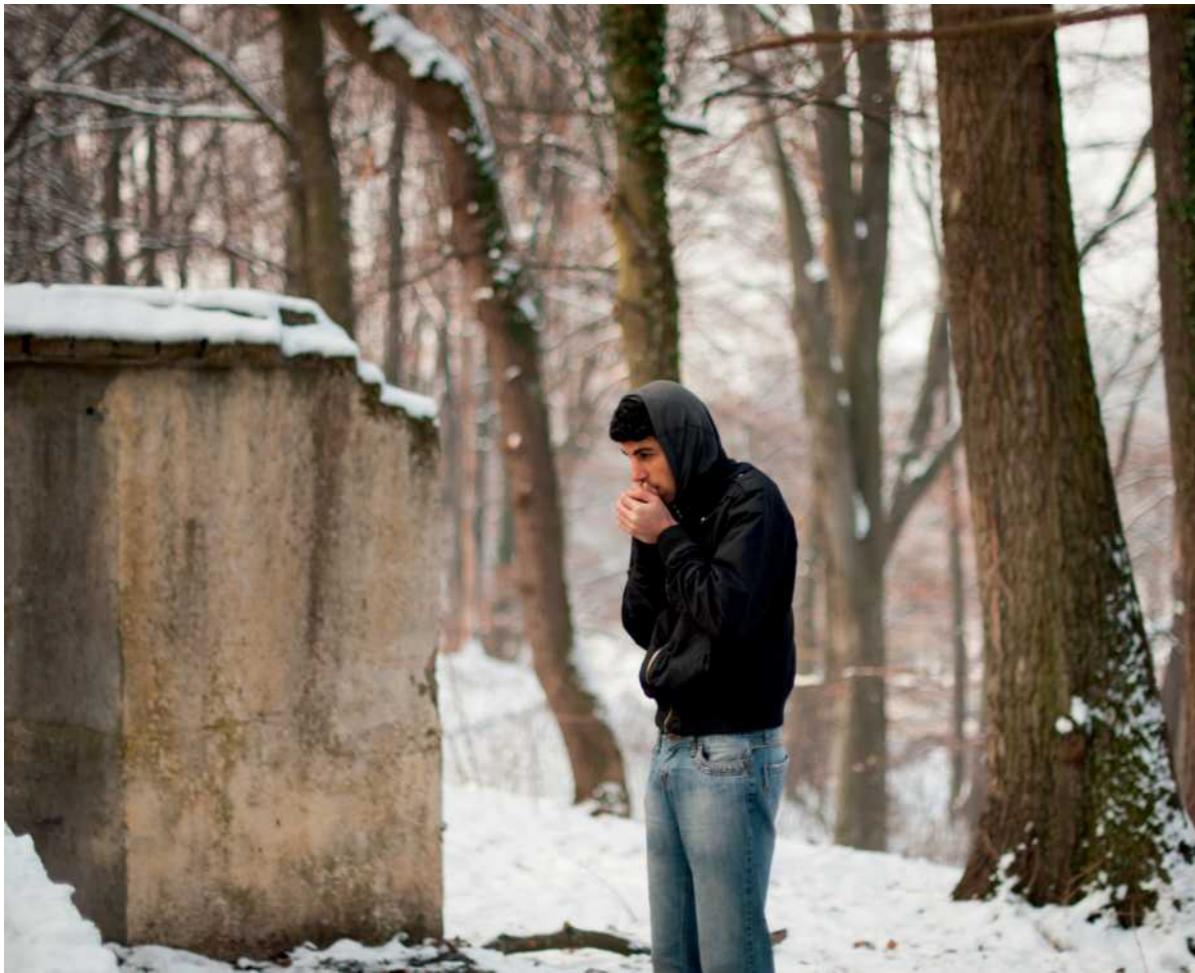

## CONTEXT REFUGEE CAMPS

- harsh climates
- heavy weather conditions



REFUGEES STAY ON AVERAGE  
14 YEARS IN A CAMPS (UNHCR)

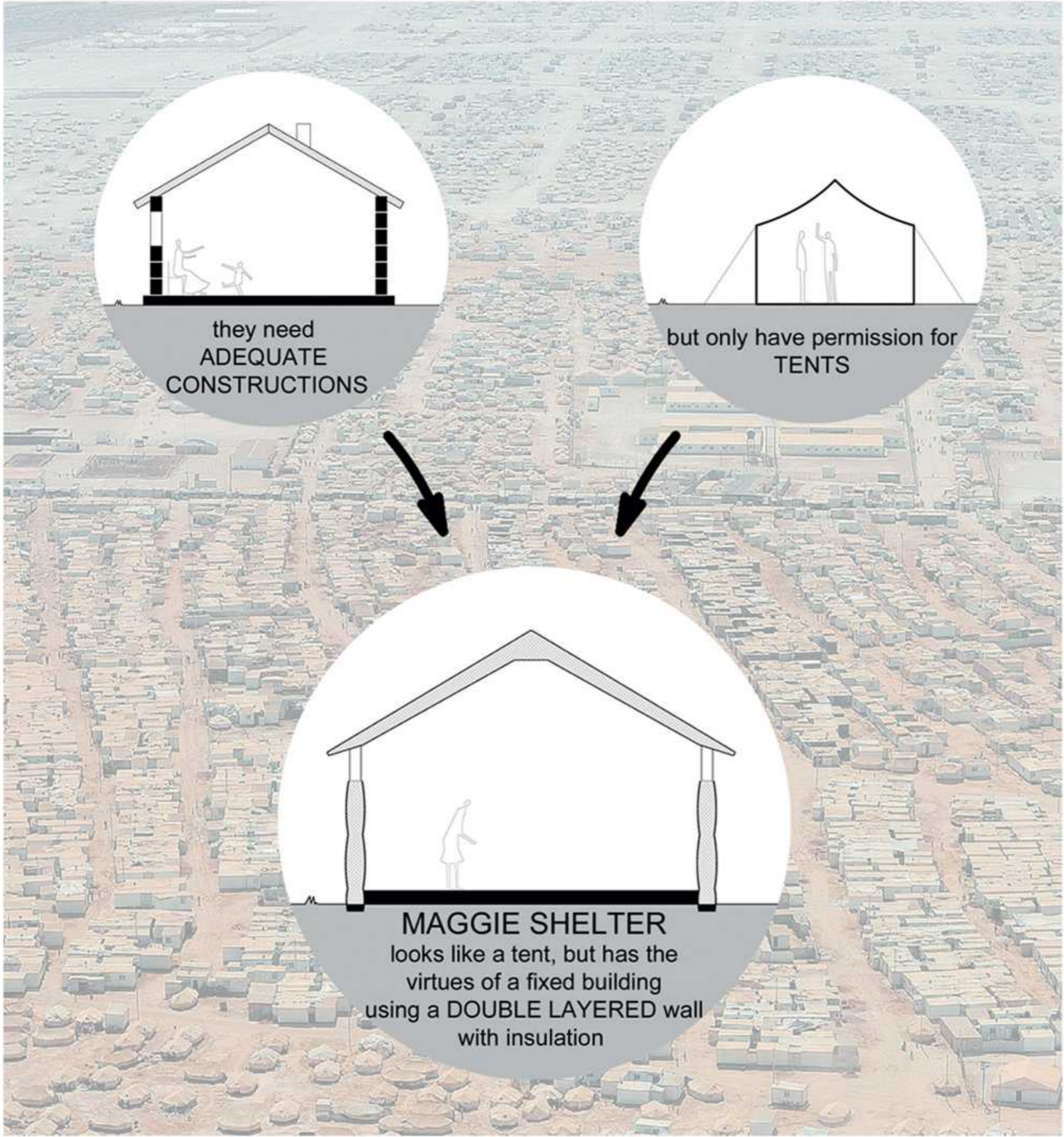

they need  
ADEQUATE  
CONSTRUCTIONS

but only have permission for  
TENTS

**MAGGIE SHELTER**  
looks like a tent, but has the  
virtues of a fixed building  
using a **DOUBLE LAYERED** wall  
with insulation

THE MAGGIE CONCEPT

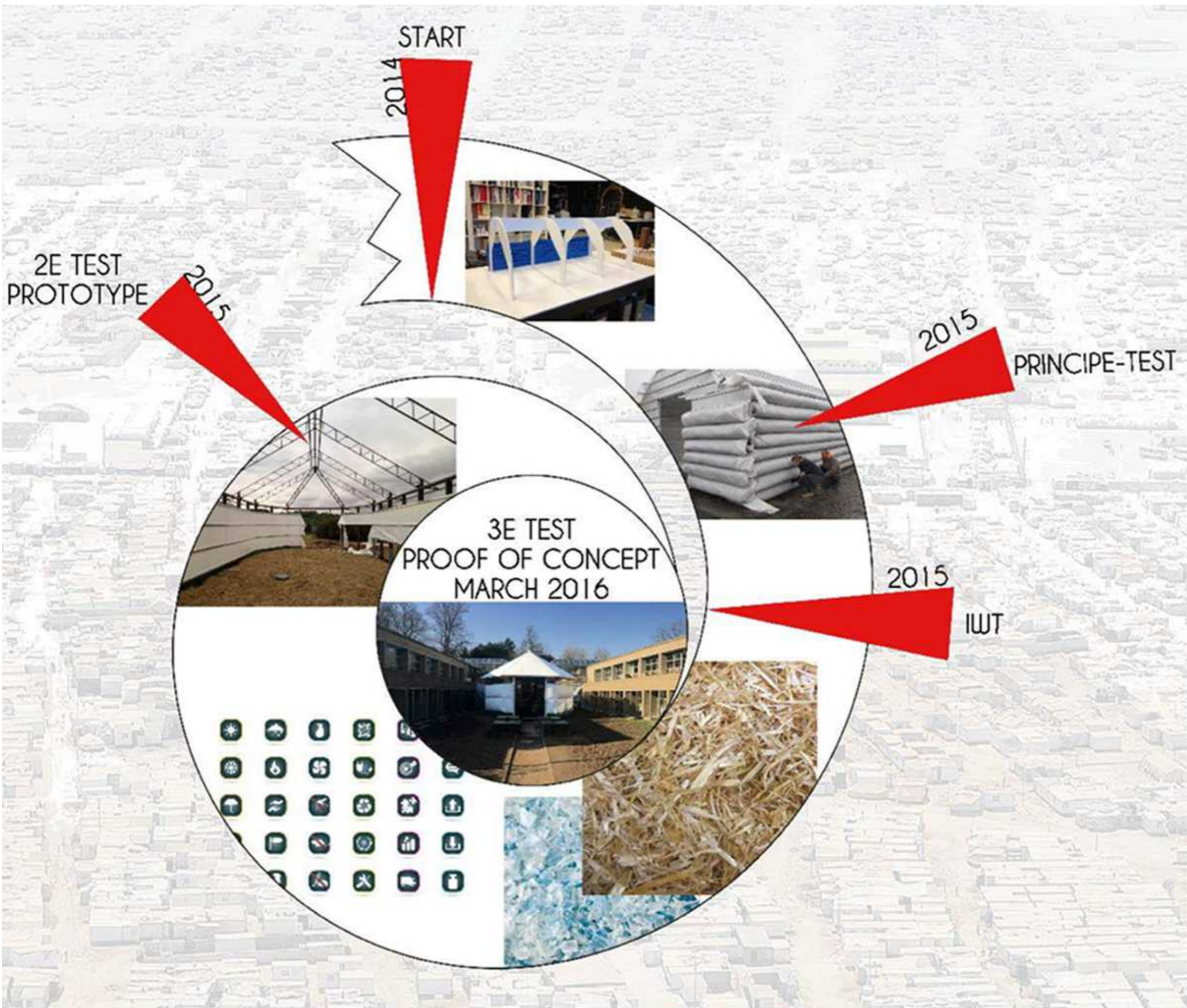

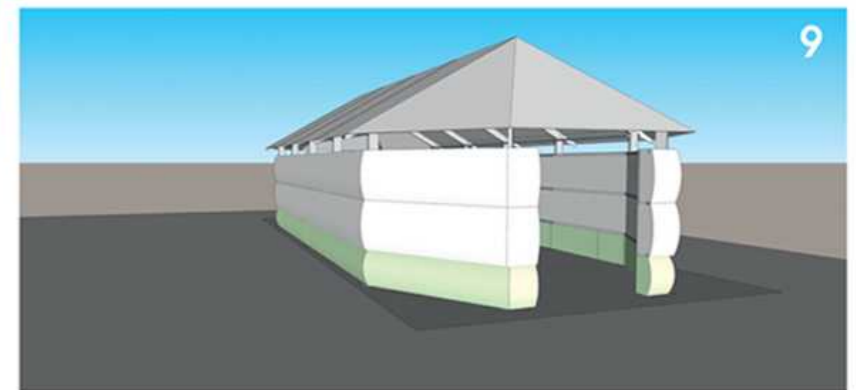
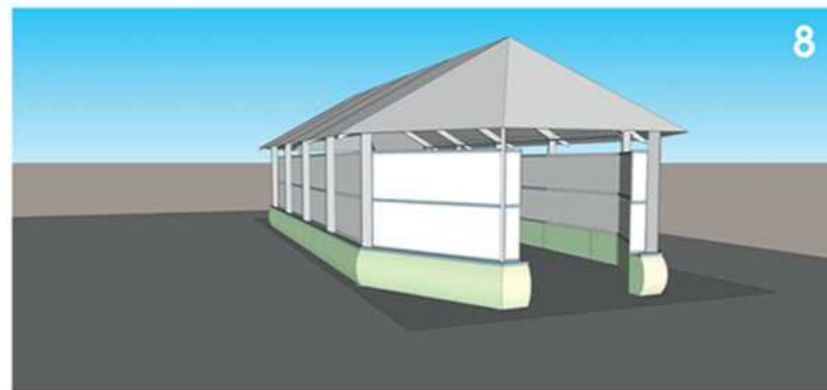
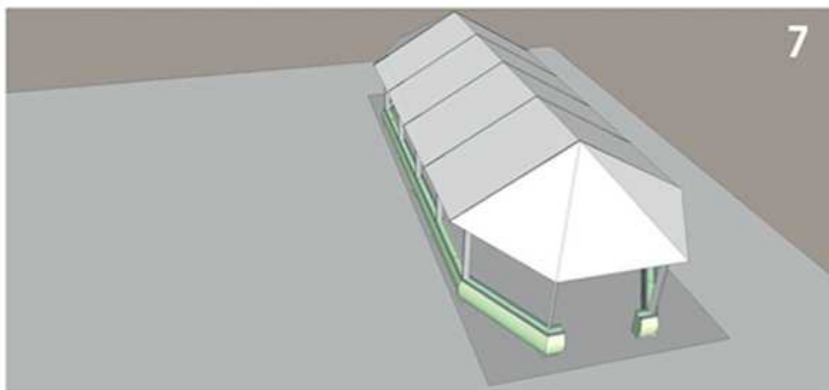
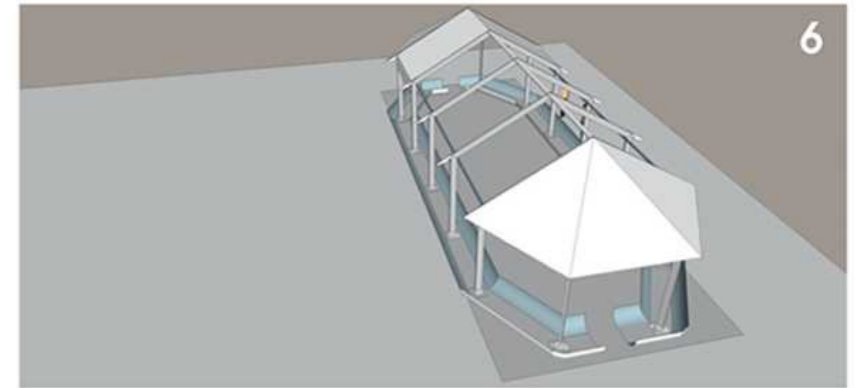
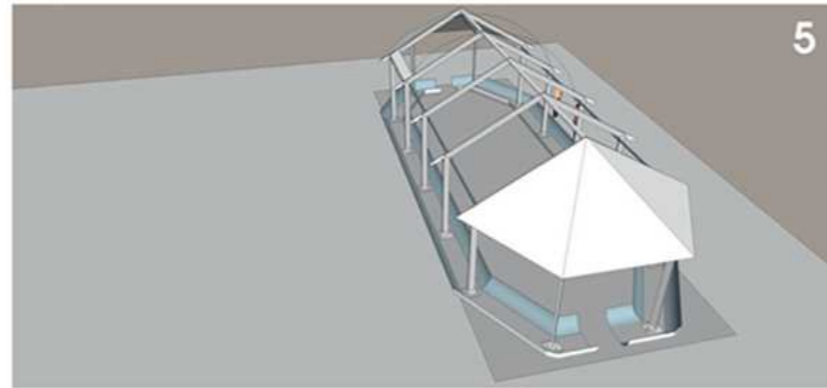
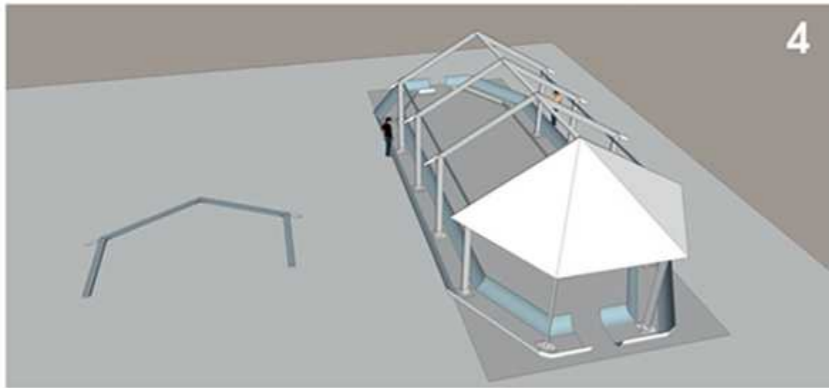
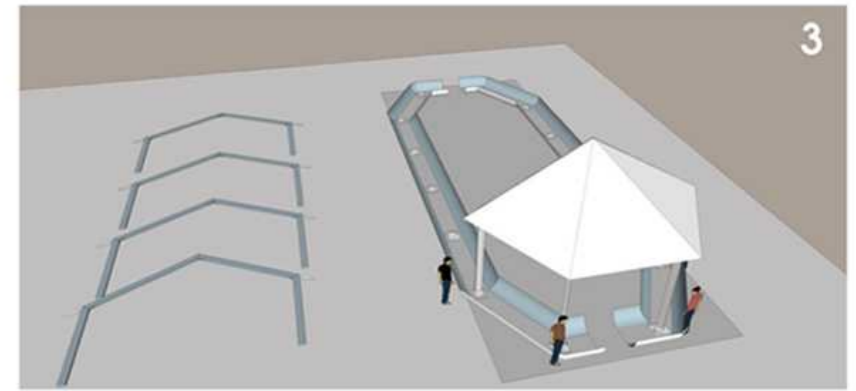
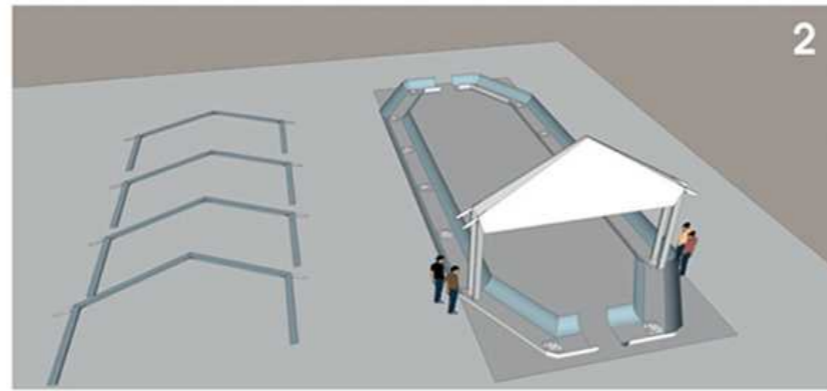
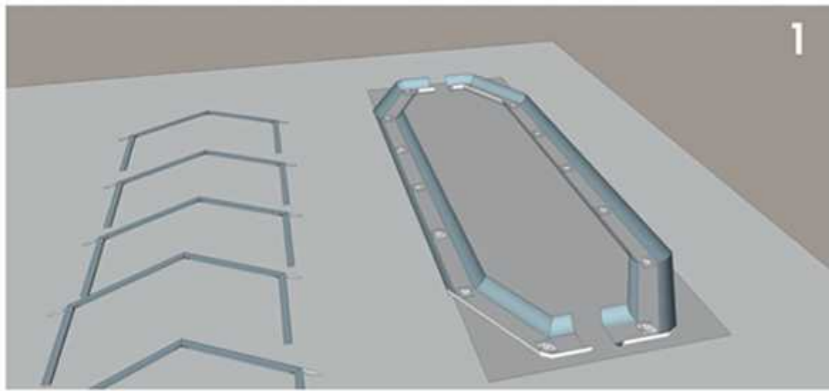

## HOW TO BUILD A MAGGIE





FIRST CONCEPTUAL TEST



TEXTILE TESTING







PROOF OF CONCEPT APRIL 2016  
@ open Minor Age Refugee Center  
Steenokkerzeel Belgium - FEDASIL











## The **maggie** shelter

A solution when and where fixed structures are not permitted, practical or desired. The maggie is a sturdy, highly-insulated, sustainable shelter that is adaptable to all climates.

**A temporary shelter with the benefits of a building.**



LET'S BUILD OPPORTUNITIES

# MAGGIE 4

ready to deliver





## FIRST PROMOTION OF MAGGIE SHELTER

@ World Humanitarian Summit

June 2016 - Istanbul - Turkey

(visit op minister Alexander De Croo)







PANEL DABATE @ European Commission - Innovation meets humanitarian Aid



## MAGGIE AWARDS

- 2016 Henry Van de Velde Design Award
- 2016 Aidex Innovation Challenge Finalist
- 2018 Belgian Building Awards
- 2019 DCHI award - best Humanitarian Innovation

## MAGGIE PUBLICATIONS

- MoMa NEW YORK
- Architecture Biennale Venice
- Rijksmuseum Amsterdam



# PARTNER UP?

DOING A FIRST INTERNATIONAL PILOT  
PROJECT WITH A BIG NGO OR A UN-PARTNER  
SEEMED BARELY IMPOSSIBLE....  
SO MAGGIE CHANGED IT'S COURSE AND STARTED  
LOOKING FOR FIRST PILOT'S TOGETHER WITH  
SMALL LOCAL ACTORS THAT ARE DOING GREAT WORK

NEED



Concept Maggie goes to ...  
#MgT

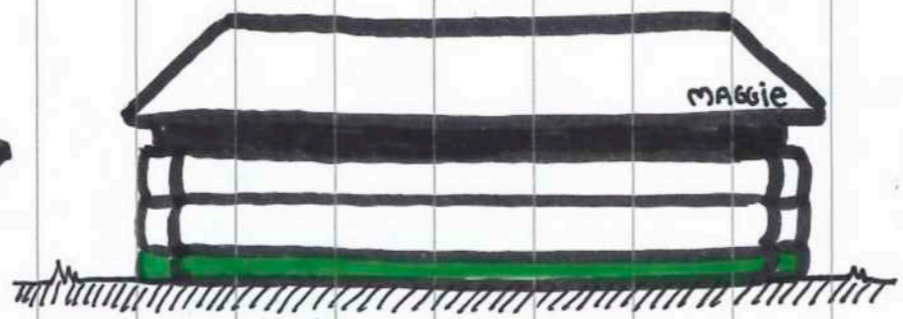

SEED

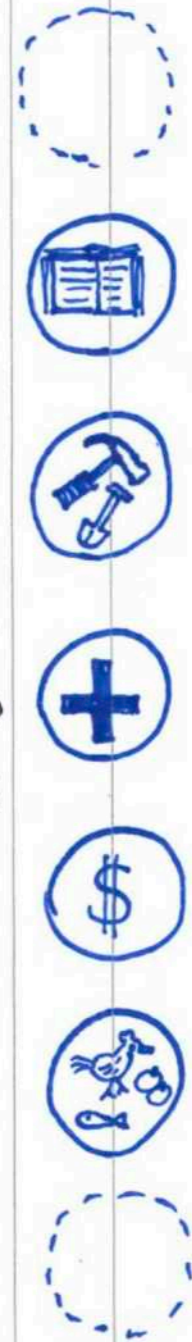

SKILLS

TO

REPEAT

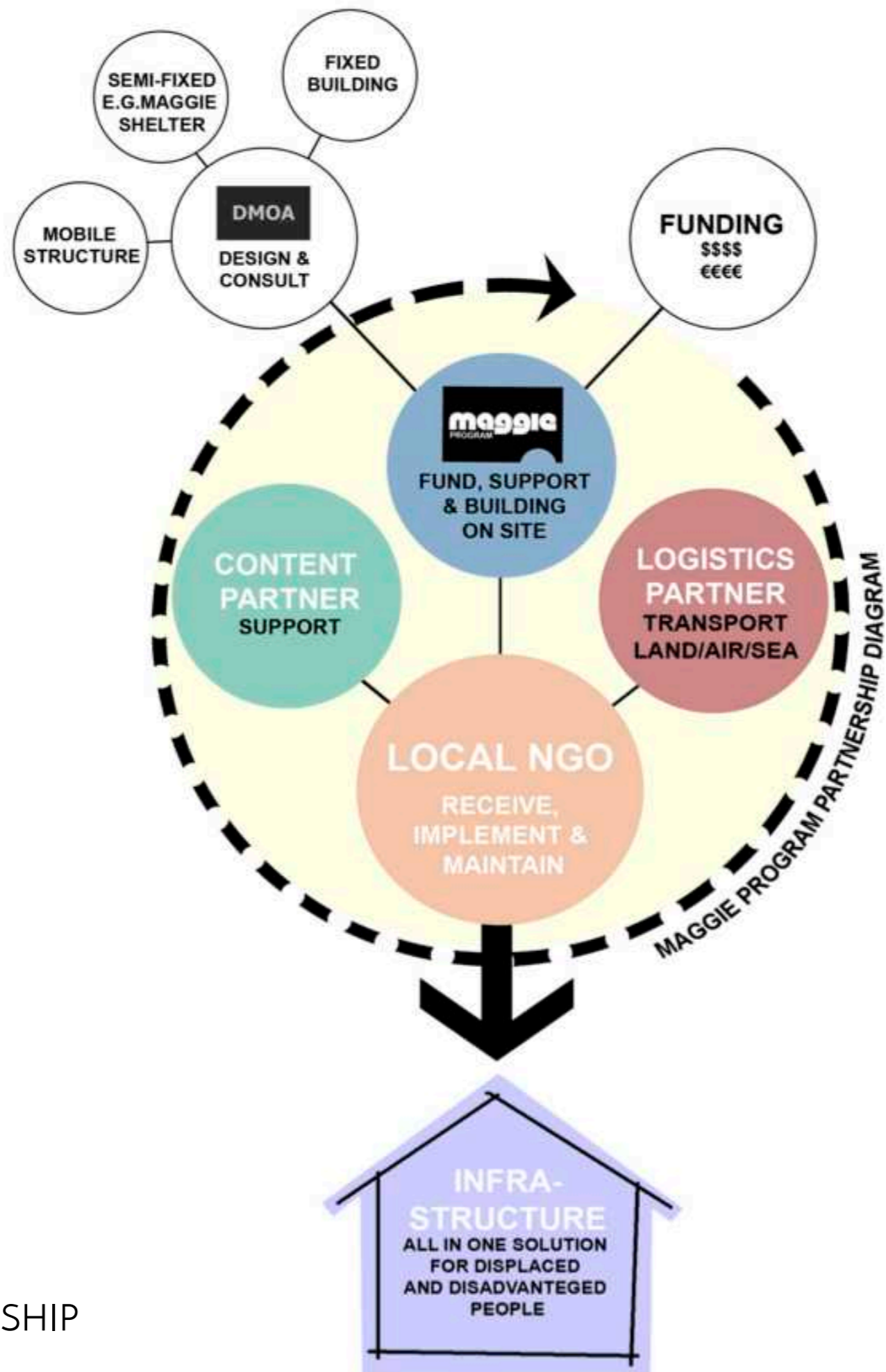

THE MAGGIE PARTNERSHIP

# THE BOTTOM UP APPROACH OF MAGGIE PROGRAM

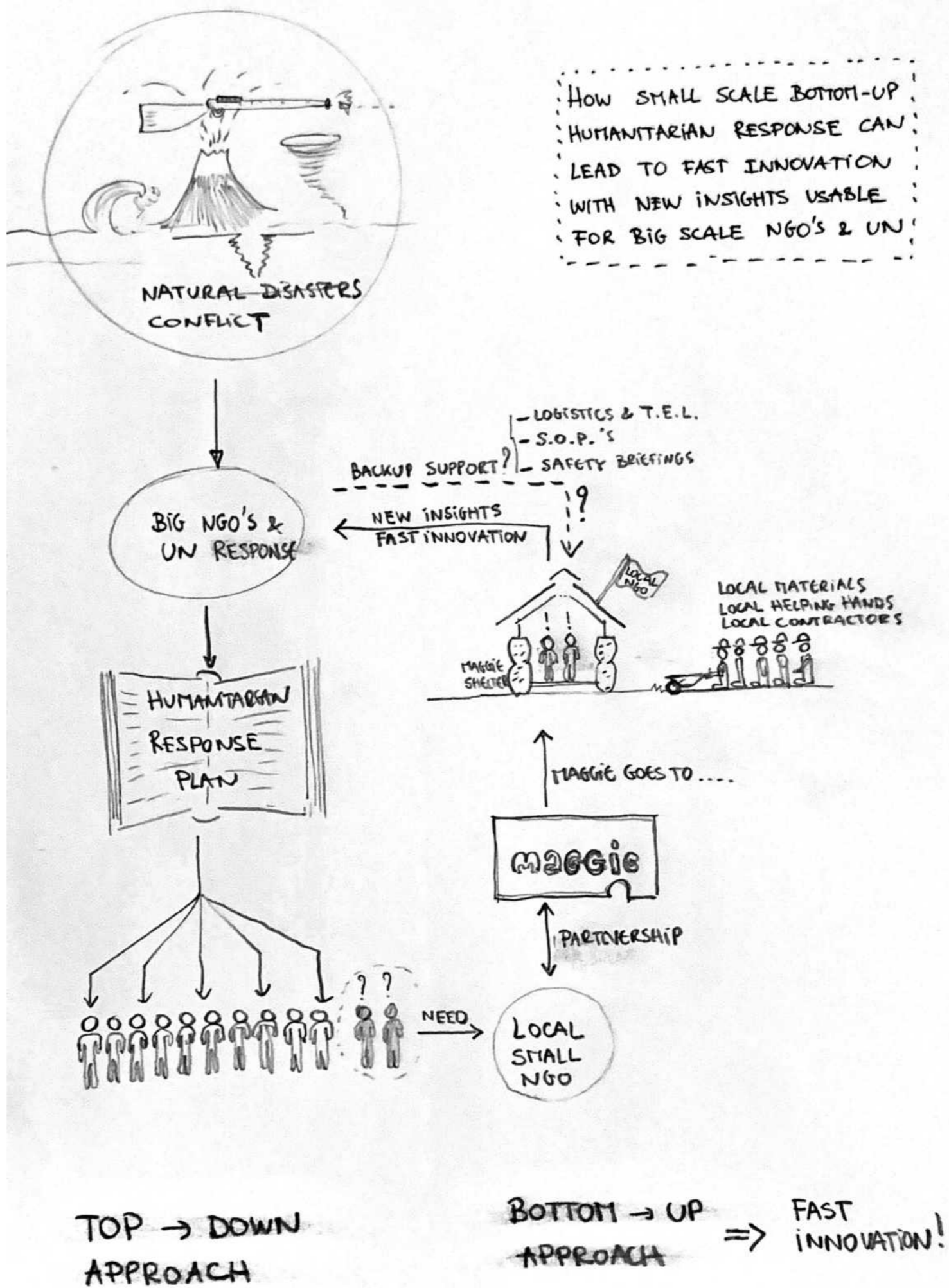



UPDATES FROM  
MAGGIE PROGRAM

watch movie: <https://vimeo.com/288741229>





FINDING DONORS TO RAISE 60.000 €



GROUND PREPARATION CAMEROON



2 MAGGIE'S (800 m<sup>3</sup>) FIT IN 1 SMALL 20ft CONTAINER OF 30m<sup>3</sup>





WORKING TOGETHER WITH LOCAL HELPING HANDS





A RAISED FLOOR IS FUNDAMENTAL FOR GOOD INFRASTRUCTURE



FILLING THE MAGGIE WALLS WITH 30 TONS OF CLAY GROUND  
THE TENT BECOMING A STURDY BUILDING







MAGGIE GOES TO YEZIDI





PANAGA ORGANISATION FOR EDUCATION (Zirak Hameed)  
Trauma Psychologists working with children - victims of war



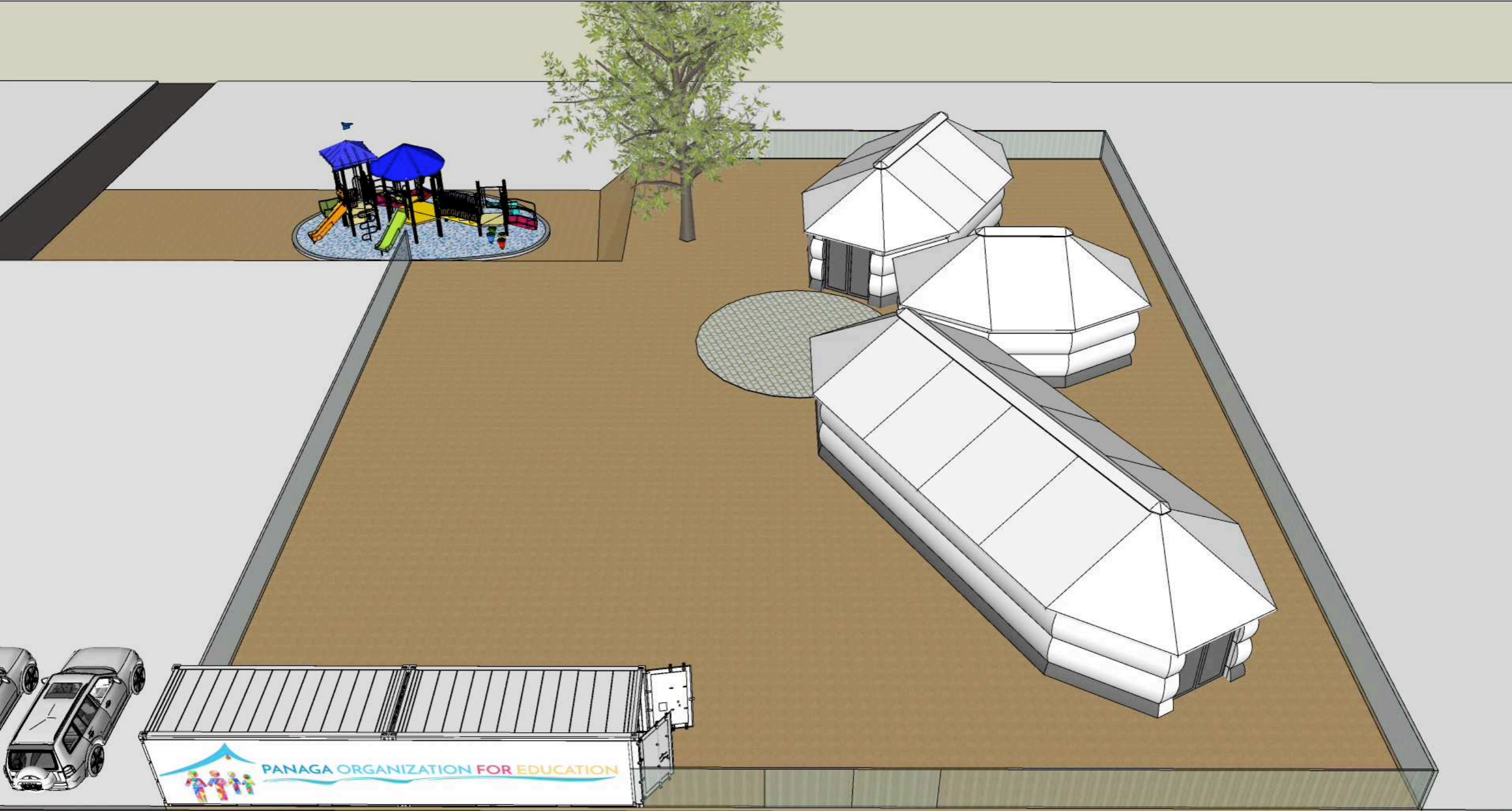

The Maggie School for trauma healing

































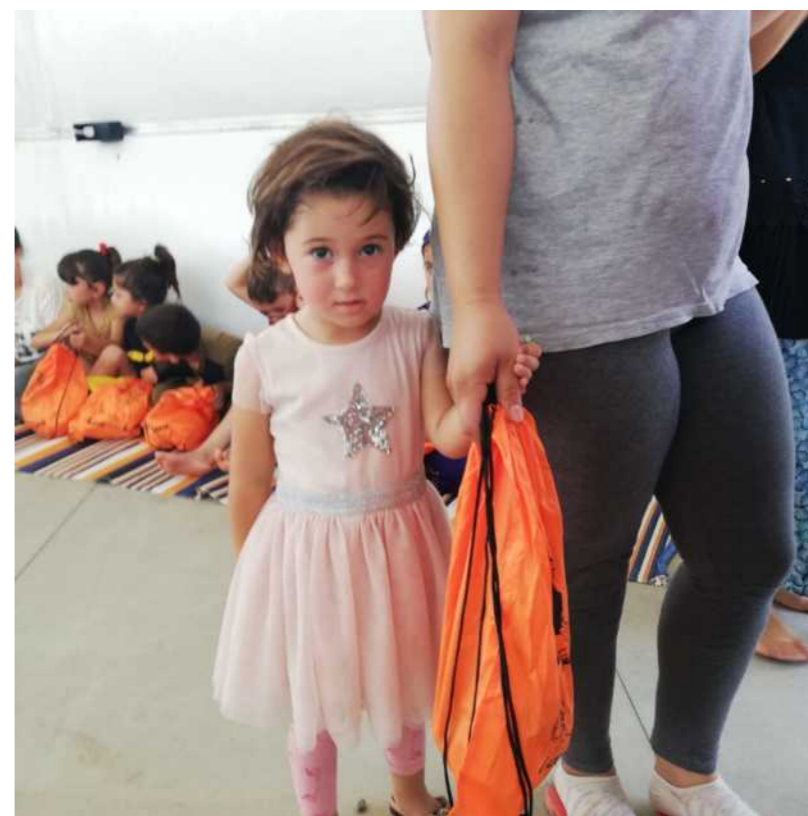

MAGGIE GOES TO KAKUMA

# SKYPE SCHOOL FOR DISTANCE LEARNING AND TEACH THE TEACHER PROGRAMS









KOEN TIMMERS



DR. JANE GOODALL









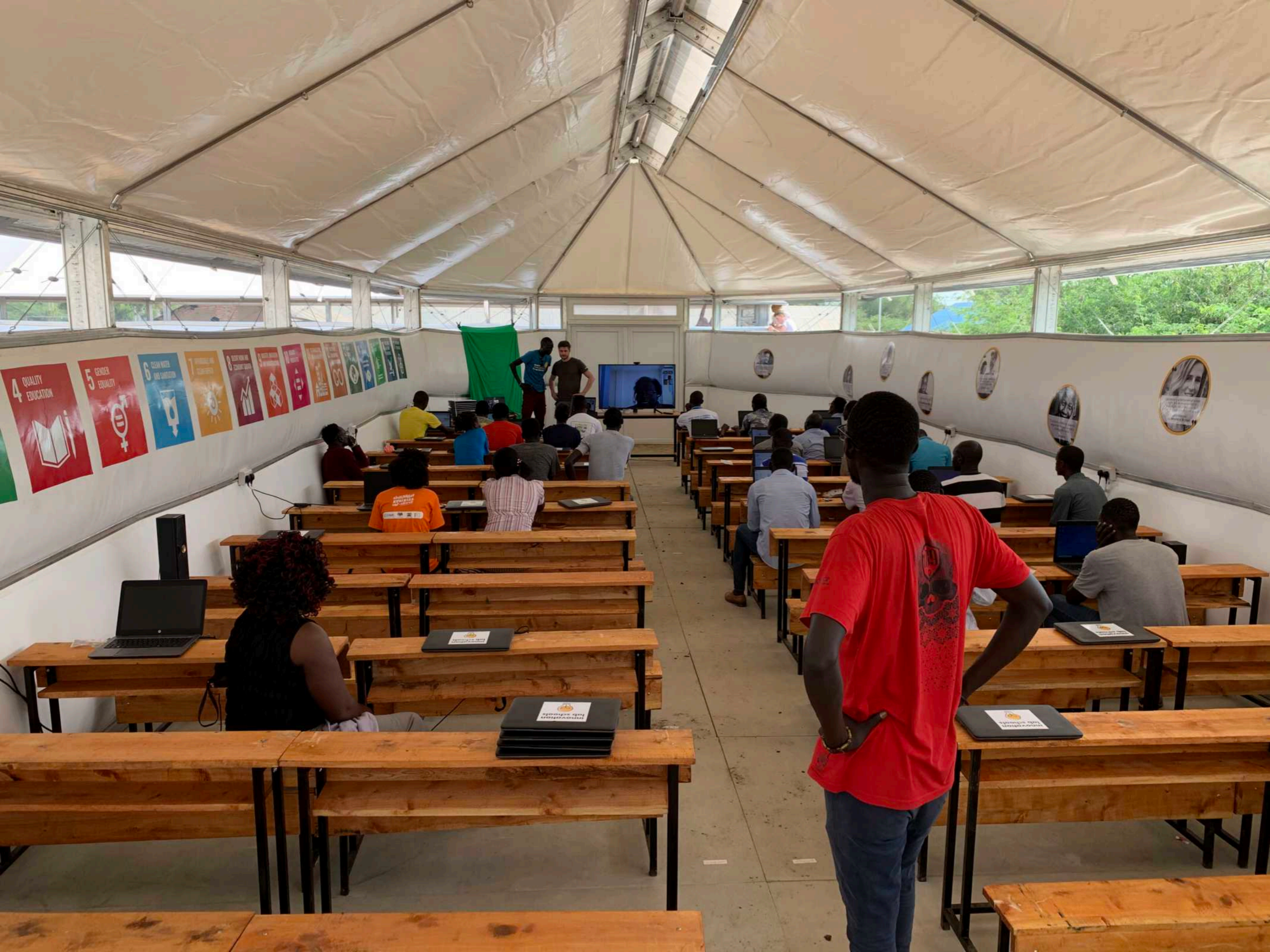

MAGGIE GOES TO LEUVEN  
een pilootproject voor een  
nieuw Noord - Zuid concept



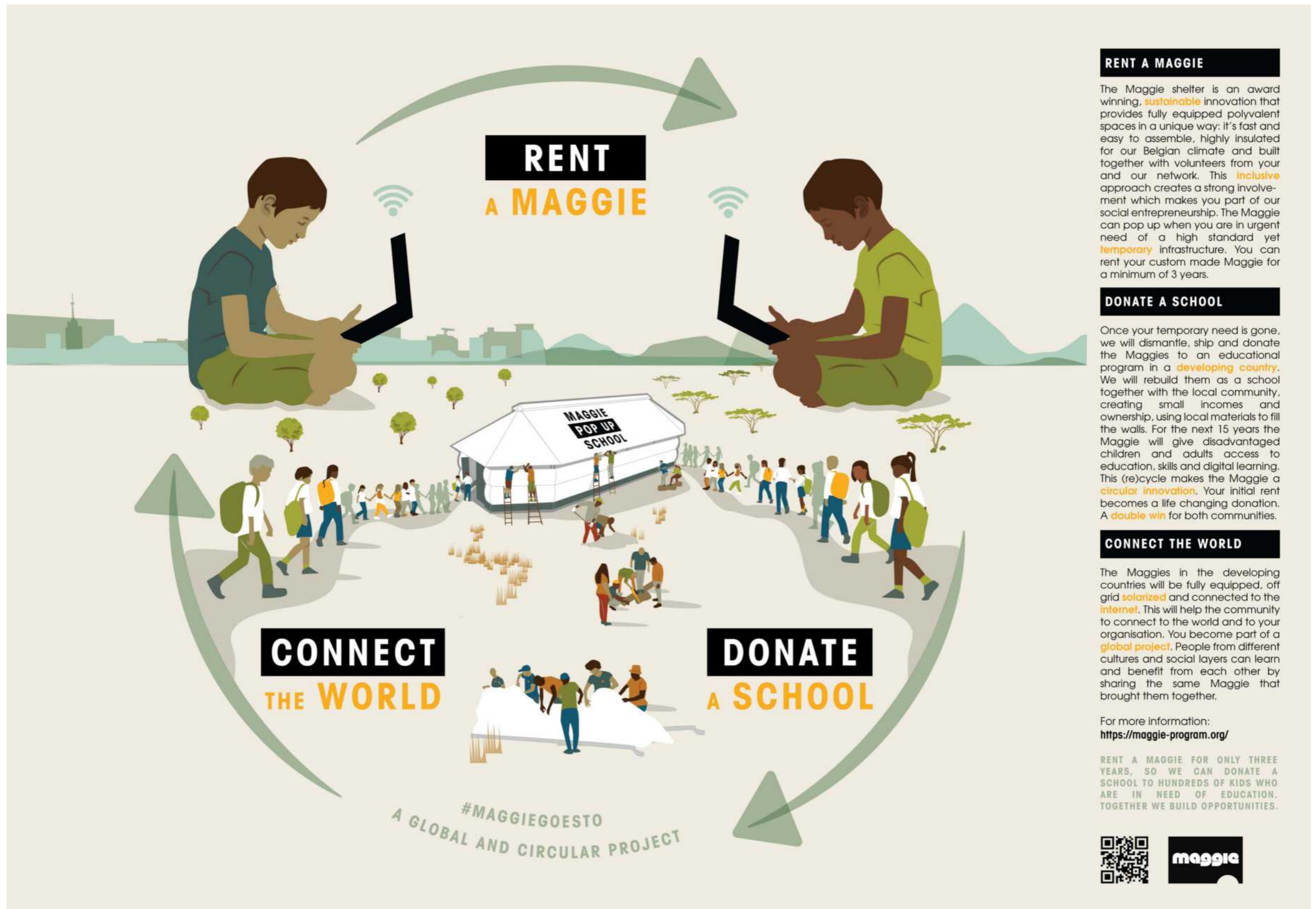

#### RENT A MAGGIE

The Maggie shelter is an award winning, **sustainable** innovation that provides fully equipped polyvalent spaces in a unique way: it's fast and easy to assemble, highly insulated for our Belgian climate and built together with volunteers from your and our network. This **inclusive** approach creates a strong involvement which makes you part of our social entrepreneurship. The Maggie can pop up when you are in urgent need of a high standard yet **temporary** infrastructure. You can rent your custom made Maggie for a minimum of 3 years.

#### DONATE A SCHOOL

Once your temporary need is gone, we will dismantle, ship and donate the Maggies to an educational program in a **developing country**. We will rebuild them as a school together with the local community, creating small incomes and ownership, using local materials to fill the walls. For the next 15 years the Maggie will give disadvantaged children and adults access to education, skills and digital learning. This (re)cycle makes the Maggie a **circular innovation**. Your initial rent becomes a life changing donation. A **double win** for both communities.

#### CONNECT THE WORLD

The Maggies in the developing countries will be fully equipped, off grid **solarized** and connected to the **internet**. This will help the community to connect to the world and to your organisation. You become part of a **global project**. People from different cultures and social layers can learn and benefit from each other by sharing the same Maggie that brought them together.

For more information:  
<https://maggie-program.org/>

RENT A MAGGIE FOR ONLY THREE YEARS, SO WE CAN DONATE A SCHOOL TO HUNDREDS OF KIDS WHO ARE IN NEED OF EDUCATION. TOGETHER WE BUILD OPPORTUNITIES.



watch concept movie: <https://vimeo.com/442743335>



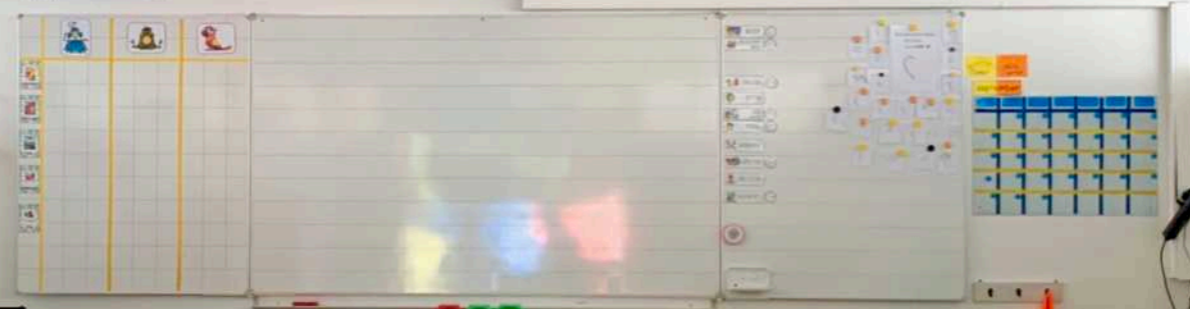

LONG TERM MISSION:  
MAGGIE = GAMECHANGER

**UPGRADABILITY** AS GAMECHANGER  
IN HUMANITARIAN AID

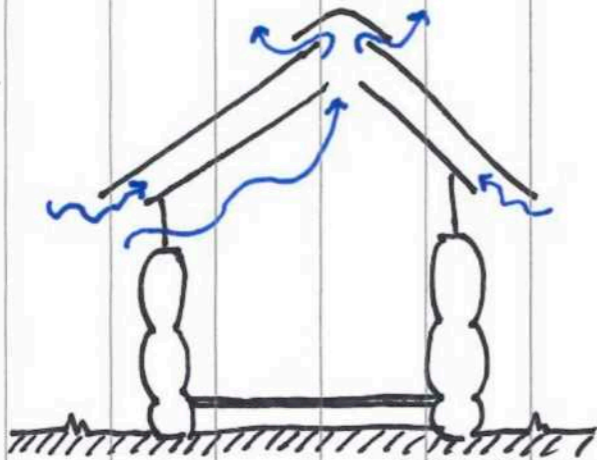

DAY 1  
MAGGIE YEAR 1  
**URGENCY**  
ASSEMBLED IN 1 DAY

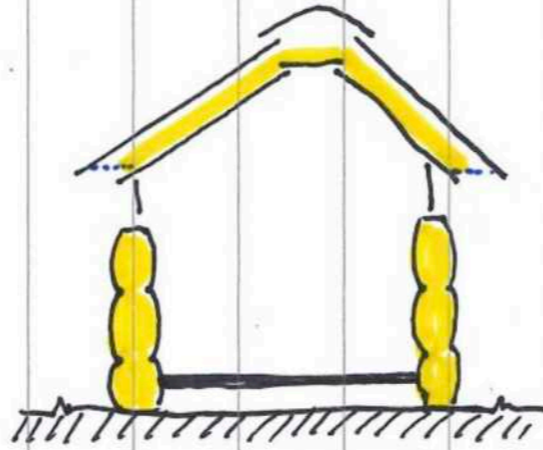

MAGGIE 0 → 15 YEARS  
**MID TERM**  
FILLED WITH LOCAL  
MATERIALS BY THE  
LOCAL COMMUNITY  
IN A FEW DAYS

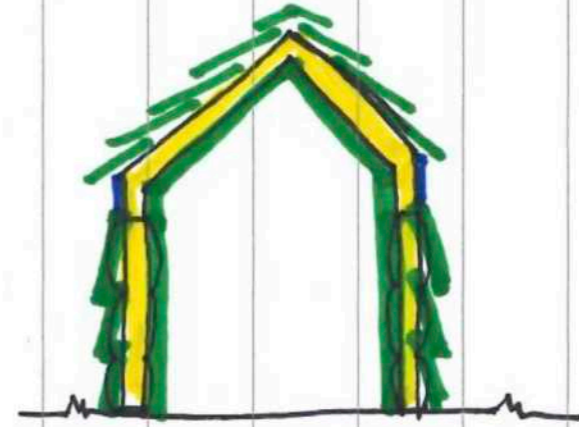

MAGGIE STRUCTURE > 15 Y.  
**LONG TERM**  
DISMANTLED TO THE  
NAKED ALU STRUCTURE  
AND COVERED WITH  
LOCAL CLADDING AND WALLS

**THE MAGGIE LIFE CYCLE**



[www.DMOA.be](http://www.DMOA.be)

[www.maggie-program.org](http://www.maggie-program.org)

[www.fb.com/maggiiprogram](https://www.facebook.com/maggiiprogram)

[www.fb.com/dmoaarchitecten](https://www.facebook.com/dmoaarchitecten)